

DIMENSIONS OF PLAIN FLANGES ■ B.S 10 : 1962

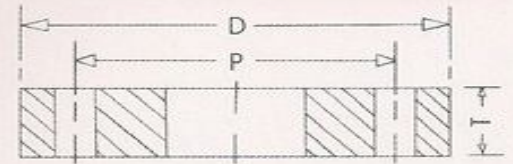

TABLE - D : For Working Steam Pressure upto 50 lbs./sq. inch

Flange Size Designation (Nominal Bore of Pipe)	Approx. Outside Diameter of Steel Pipe H		Diameter of Flange		Bolt Circle Diameter		Number of Bolt Holes N	Diameter of Bolts B*		Thickness T	
	inch	mm	inch	mm	inch	mm		inch	mm	inch	mm
1/2	27/32	21.43	3 3/4	95.25	2 5/8	66.68	4	1/2	12.70	3/16	4.76
3/4	1 1/16	26.99	4	101.60	2 7/8	73.03	4	1/2	12.70	3/16	4.76
1	1 11/32	34.13	4 1/2	114.30	3 1/4	82.55	4	1/2	12.70	3/16	4.76
1 1/4	1 11/16	42.86	4 3/4	120.65	3 7/16	87.31	4	1/2	12.70	1/4	6.35
1 1/2	1 29/32	48.42	5 1/4	133.35	3 7/8	98.43	4	1/2	12.70	1/4	6.35
2	2 3/8	60.33	6	152.40	4 1/2	114.30	4	5/8	15.88	5/16	7.94
2 1/2	3	76.20	6 1/2	165.10	5	127.00	4	5/8	15.88	5/16	7.94
3	3 1/2	88.90	7 1/4	184.15	5 3/4	146.05	4	5/8	15.88	3/8	9.53
3 1/2	4	101.60	8	203.20	6 1/2	165.10	4	5/8	15.88	3/8	9.53
4	4 1/2	114.30	8 1/2	215.90	7	177.80	4	5/8	15.88	3/8	9.53
5	5 1/2	139.70	10	254.00	8 1/4	209.55	8	5/8	15.88	1/2	12.70
6	6 1/2	165.10	11	279.40	9 1/4	234.95	8	5/8	15.88	1/2	12.70
	6 5/8	168.28									
7	7 5/8	193.68	12	304.80	10 1/4	260.35	8	5/8	15.88	1/2	12.70
8	8 5/8	219.08	13 1/4	336.55	11 1/2	292.10	8	5/8	15.88	1/2	12.70
9	9 5/8	244.48	14 1/2	368.30	12 3/4	323.85	8	5/8	15.88	5/8	15.88
10	10 3/4	273.05	16	406.40	14	355.60	8	3/4	19.05	5/8	15.88
12	12 3/4	323.85	18	457.20	16	406.40	12	3/4	19.05	3/4	19.05
13	14	355.60	19 1/4	488.95	17 1/4	438.15	12	3/4	19.05	3/4	19.05
14	15	381.00	20 3/4	527.05	18 1/2	469.90	12	7/8	22.23	7/8	22.23
15	16	406.40	21 3/4	552.45	19 1/2	495.30	12	7/8	22.23	7/8	22.23
16	-	-	22 3/4	577.85	20 1/2	520.70	12	7/8	22.23	7/8	22.23
17	18	457.20	24	609.60	21 3/4	552.45	12	7/8	22.23	1	25.40
18	-	-	25 1/4	641.35	23	584.20	12	7/8	22.23	1	25.40
19	20	508.00	26 1/2	673.10	24	609.60	12	7/8	22.23	1	25.40
20	-	-	27 3/4	704.85	25 1/4	641.35	16	7/8	22.23	1 1/8	28.58
21	22	558.80	29	736.60	26 1/2	673.10	16	7/8	22.23	1 1/8	28.58
22	-	-	30	762.00	27 1/2	698.50	16	1	25.40	1 1/8	28.58
23	24	609.60	31	787.40	28 1/2	723.90	16	1	25.40	1 1/8	28.58
24	-	-	32 1/2	825.50	29 3/4	755.65	16	1	25.40	1 1/4	31.75

NOTE : B* - For 1/2" & 5/8" Bolts, diameter of holes shall be 1/16"(1.6 mm) larger than the bolt and for 3/4" bolts & sizes above, diameter of hole shall be not more than 1/8"(3.2 mm) larger than the bolts.